



Ventilation Series

APB Series / APB系列

Blind Ventilation Fan 半塑橱窗扇

Installation: Wall mounted
安装方式: 墙壁
Material: Plastic & steel
材质: 塑料 & 铁

Application icons:
适用环境

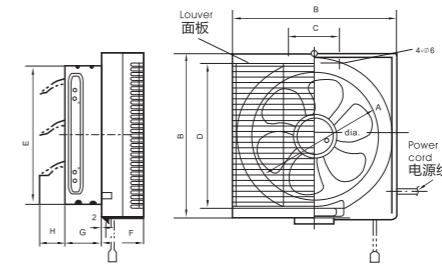

Names of Parts and Installing Dimensions(mm) 部件名称及安装尺寸

Sized 尺寸	Model 型号	A	B	C	D	E	F	G	H
150mm(6")	APB15A APB15C	150	233	132	233	182	30	82	60
	APB15B APB15D	150	233	132	296	240	63	82	60
200mm(8")	APB20A APB20C	190	296	173	296	240	42	82	60
	APB20B APB20D	190	296	173	296	240	67	82	60
250mm(10")	APB25A APB25C	237	335	210	335	290	35	82	60
	APB25B APB25D	237	335	210	335	290	56	82	60
300mm(12")	APB30A APB30C	270	390	240	390	340	44	82	60
	APB30B APB30D	270	390	240	390	340	61	82	60

Technical parameter 性能参数表

Sized 尺寸	Model 型号	Rating voltage 额定电压 [V~]	Rating frequency 额定频率 [Hz]	Power 额定功率 [W]	Air delivery 风量 [M ³ /h]	Noise 噪音 [dB]	Package Specification 包装规格		
							Dimension(cm) 尺寸	Carton Qty(set) 装箱数	Total Weight(kg) 重量
Air pressure type 风压式	W/O office 不带网罩	220~	50	23	220	39	68.5x26.2x52.0	10	14.5
				28	460	44	73.3x32.3x33.1	6	10.8
				38	750	45	75.7x36.8x37.6	6	13.4
				48	1045	48	69.5x42.1x43.3	5	14.8
Air pressure type 风压式	with office 带网罩	220~	50	23	220	40	76.0x57.2x30.1	8	16.03
				28	460	44	69.0x53.0x36.0	6	14.53
				38	750	46	78.0x57.5x40.5	6	17.33
				48	1045	49	101x45.2x45.7	5	18.46
Unidirectional linked type 联动式	W/O office 不带网罩	220~	50	23	220	39	68.5x26.2x52.0	10	14.5
				28	460	44	73.3x32.3x33.1	6	10.8
				38	750	45	75.7x36.8x37.6	6	13.4
				48	1045	48	69.5x42.1x43.3	5	14.8
Unidirectional linked type 联动式	with office 带网罩	220~	50	23	220	40	76.0x57.2x30.1	8	16.03
				28	460	44	69.0x53.0x36.0	6	14.53
				38	750	46	78.0x57.5x40.5	6	17.33
				48	1045	49	101x45.2x45.7	5	18.46

APB Series / APB系列

2-WAY Blind Ventilation Fan 双向联动式换气扇

Installation: Wall mounted
安装方式: 墙壁
Material: Plastic & steel
材质: 塑料 & 铁

Application icons:
适用环境

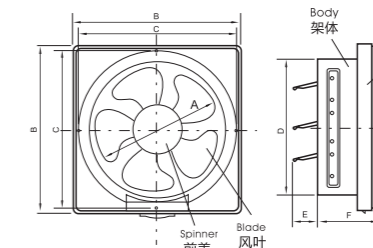

Names of Parts and Installing Dimensions(mm)

Sized 尺寸	Model 型号	A	B	C	D	E	F
150mm(6")	ASB15A	150	220	212	172	62	110
200mm(8")	ASB20A	200	295	262	241	70	102
250mm(10")	ASB25A	250	350	312	291	70	102
300mm(12")	ASB30A	300	400	364	341	75	126

Technical parameter

Description	Model 型号	Rating voltage 额定电压 [V~]	Rating frequency 额定频率 [Hz]	Power 额定功率 [W]	Air delivery 风量 [M ³ /h]	Noise 噪音 [dB]	Package Specification 包装规格		
							Dimension(cm) 尺寸	Carton Qty(set) 装箱数	Total Weight(kg) 重量
Bidirectional linked type 双向联动式	W/O office 不带网罩	220~	50	23	220	38.5	68.5x26.2x52.0	10	14.5
				28	460	42	73.3x32.3x33.1	6	10.8
				38	750	43.5	75.7x36.8x37.6	6	13.4
				48	1045	46	69.5x42.1x43.3	5	14.8

